

Building 'D' - Basement
 Gross Area: 3,962.8 S.F. (368.14 m²)
 Net Area: 3,430.8 S.F. (318.73 m²)

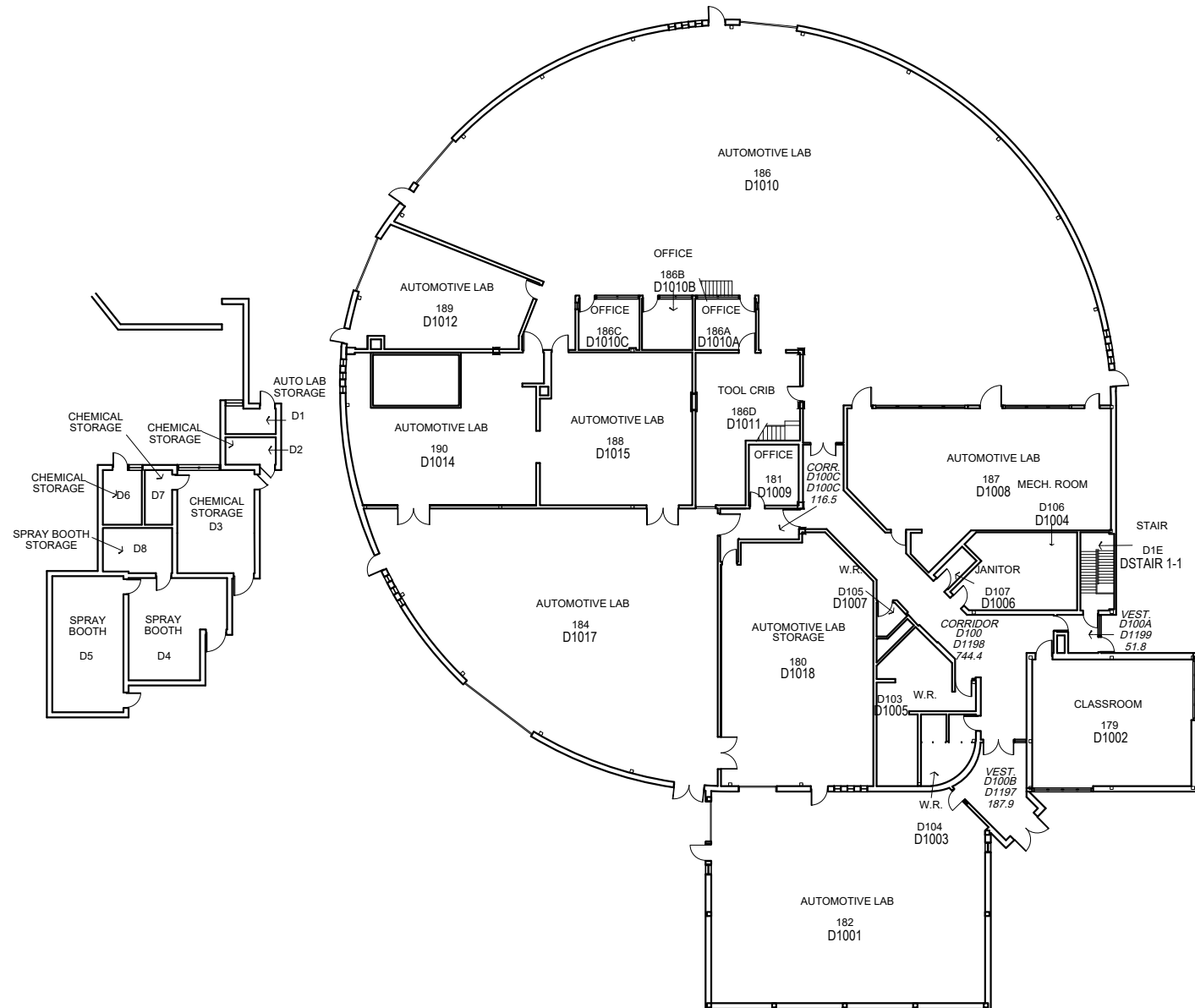

Building 'D' - First Floor
 Gross Area: 24,056.0 S.F. (2234.88 m²)
 Net Area: 22,393.6 S.F. (2080.36 m²)



FACILITIES MANAGEMENT DEPARTMENT
 2000 Talbot Road West, Windsor, ON N9A 6S4
 Ph: 519-972-2727 Fax: 519-966-7591

DRAWING NAME:

**BUILDING 'D'
 BASEMENT & FIRST FLOOR**

REVISED: **JANUARY 2023**

FILE NAME: T:\DWG\Building Plans\1 to 30\South Campus\1603d0_1.dwg

REVISED BY: **J.C.**

SCALE: $\frac{1}{32}'' = 1'-0''$



PAGE **D0000**
D1000

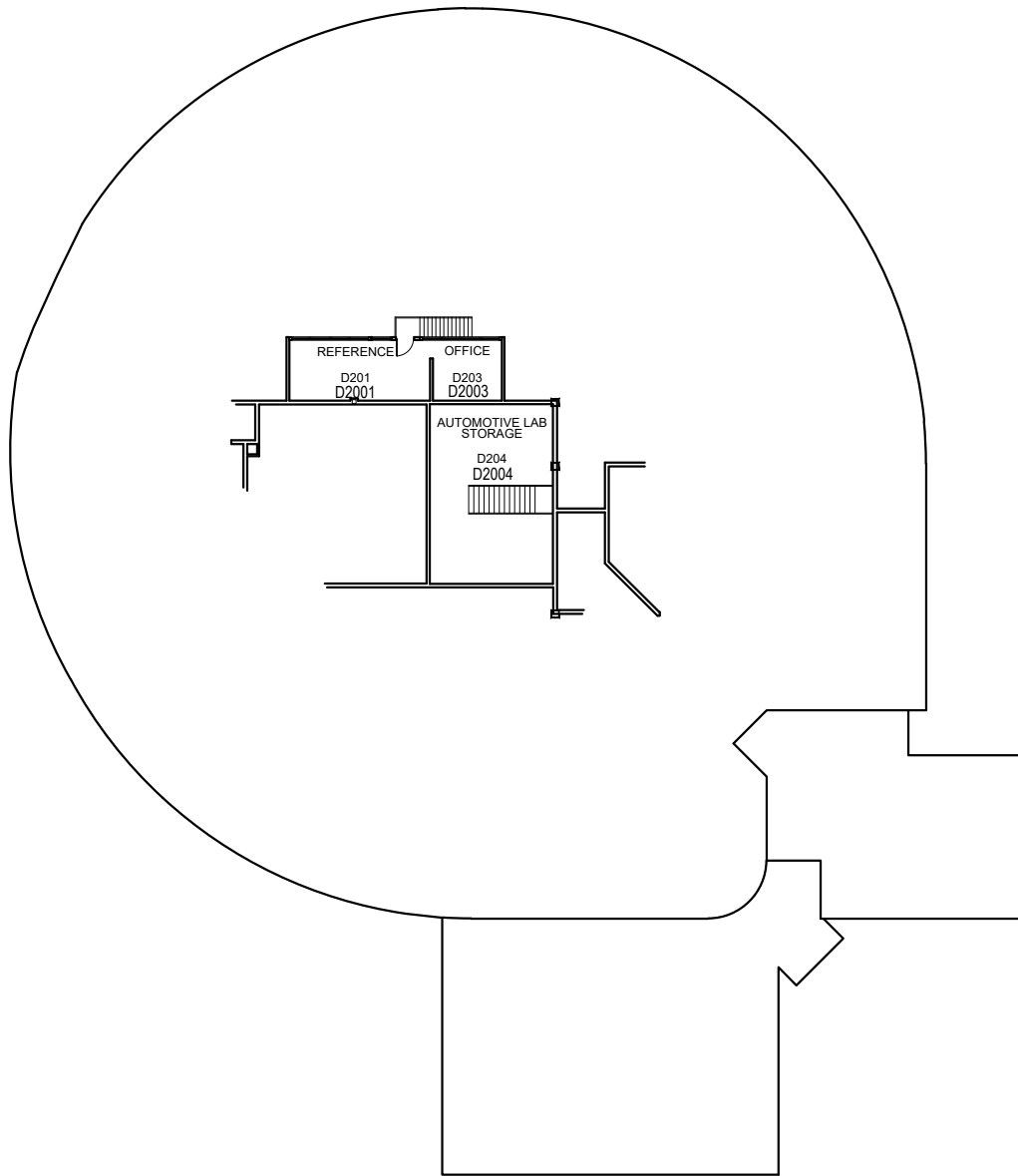

Building 'D' - Second Floor

Gross Area: 1,082.9 S.F. (100.60 m²)
 Net Area: 973.3 S.F. (90.42 m²)

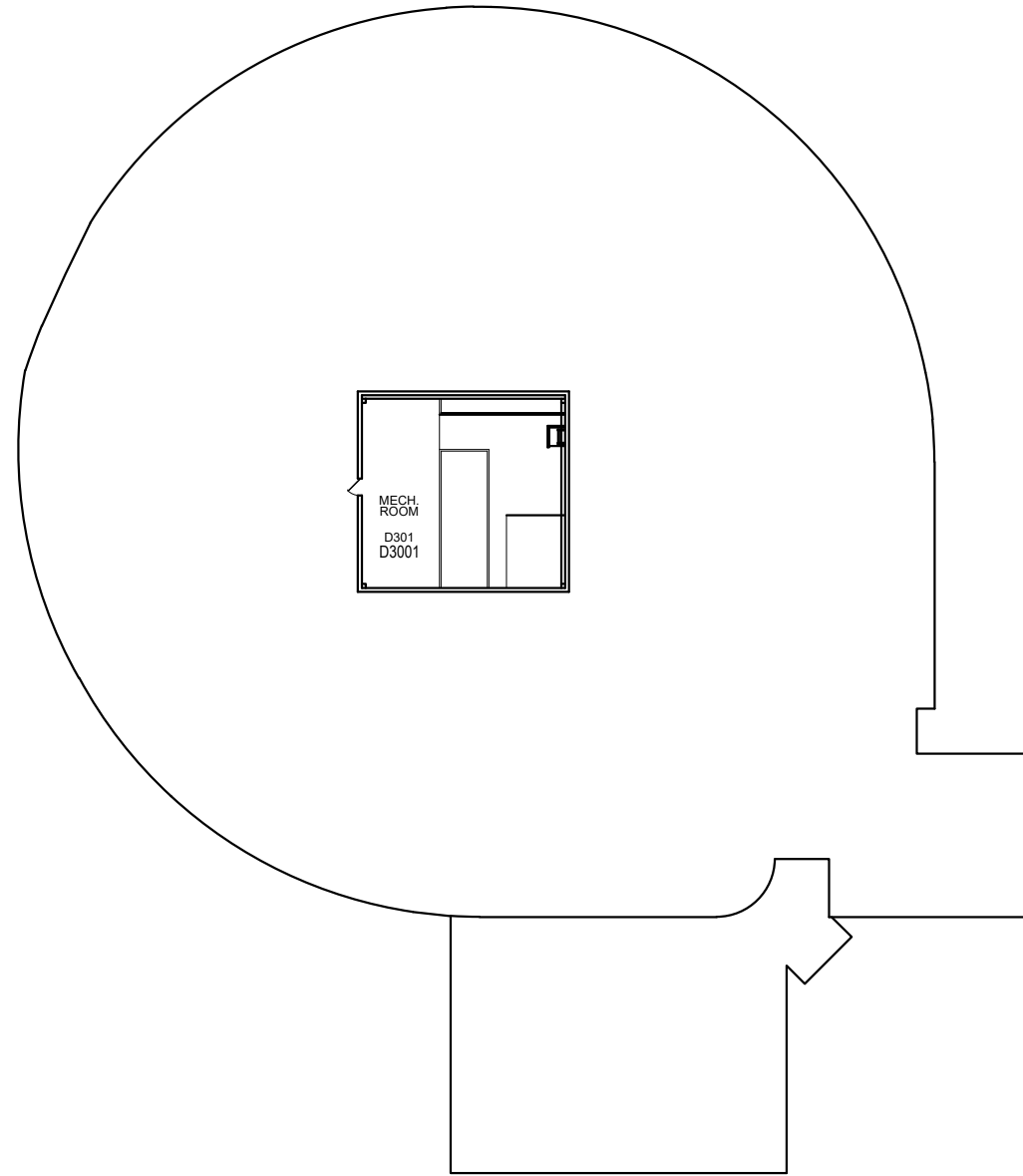

Building 'D' - Penthouse

Gross Area: 1,181.5 S.F. (109.76 m²)
 Net Area: 1,094.4 S.F. (101.67 m²)



FACILITIES MANAGEMENT DEPARTMENT
 2000 Talbot Road West, Windsor, ON N9A 6S4
 Ph: 519-972-2727 Fax: 519-966-7591

DRAWING NAME:

**BUILDING 'D'
 SECOND & PENTHOUSE**

REVISED:

JANUARY 2023

FILE NAME: T:\DWG\Building Plans\1 to 30\South
 Campus\1603d2_3.dwg

REVISED BY:

J.C.

SCALE:

$\frac{1}{32}'' = 1'-0''$



PAGE

**D2000
 D3000**