

Building 'J' - First Floor
 Gross Area: 49,956.2 S.F. (4940.93 m²)
 Net Area: 46,252.7 S.F. (4296.88 m²)



FACILITIES MANAGEMENT DEPARTMENT
 2000 Talbot Road West, Windsor, ON N9A 6S4
 Ph: 519-972-2727 Fax: 519-966-7591

DRAWING NAME:
**BUILDING 'J'
 FIRST FLOOR**

REVISED: **FEBRUARY 2023**
 FILE NAME: T:\DWG\Building Plans\1 to 30\South Campus\1615L1.dwg

REVISED BY: **J.C.**
 SCALE: $\frac{1}{32}'' = 1'-0''$



PAGE:
J1000

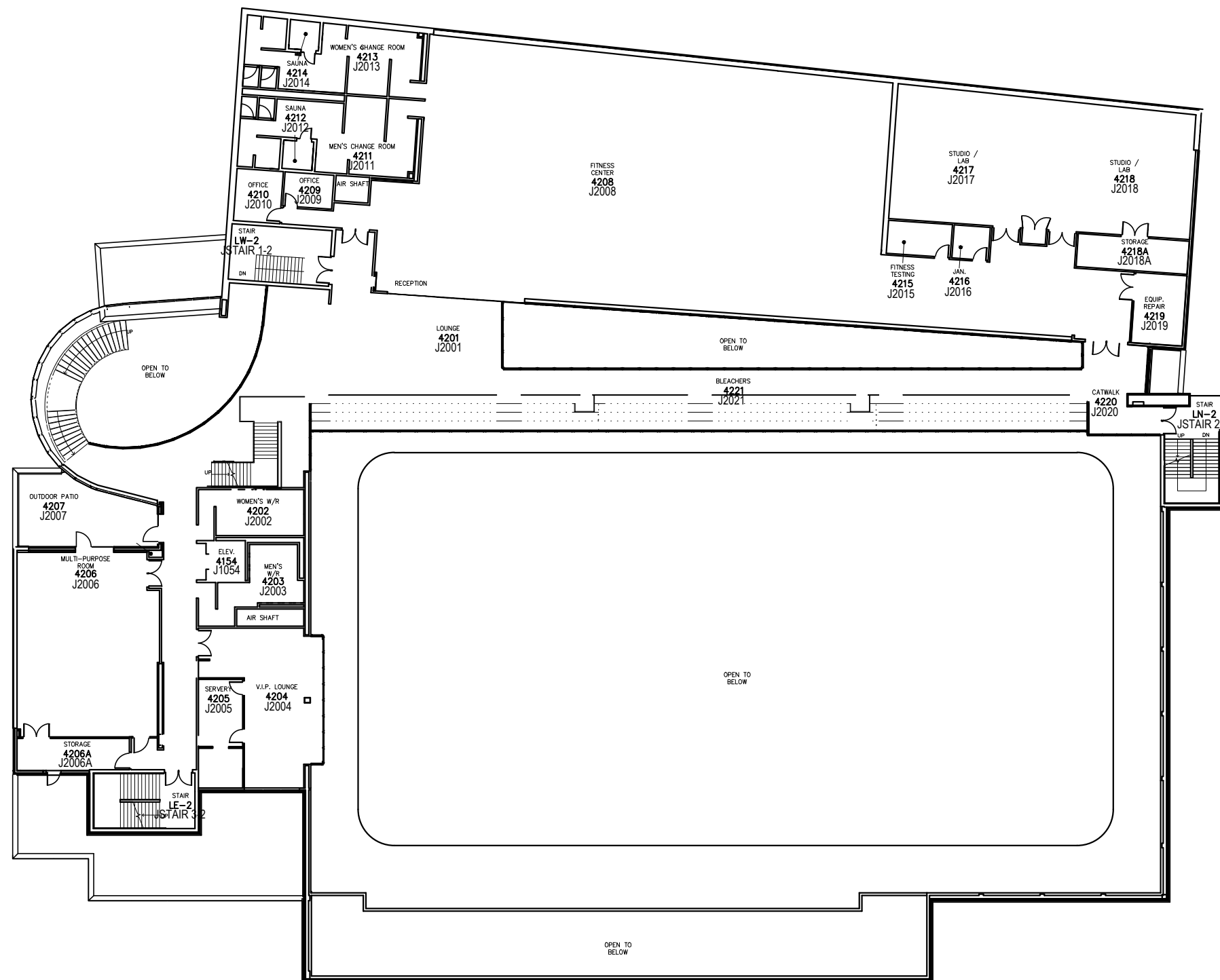

Building 'J' - Second Floor

Gross Area: 23,517.2 S.F. (2184.75 m²)
 Net Area: 20,257.2 S.F. (1881.89 m²)



FACILITIES MANAGEMENT DEPARTMENT
 2000 Talbot Road West, Windsor, ON N9A 6S4
 Ph: 519-972-2727 Fax: 519-966-7591

DRAWING NAME:

**BUILDING 'J'
 SECOND FLOOR**

REVISED: **FEBRUARY 2023**

FILE NAME: T:\DWG\Building Plans\1 to 30\South Campus\1615L2_dwg

REVISED BY: **J.C.**

SCALE: $\frac{1}{32}'' = 1'-0''$



PAGE:

J2000

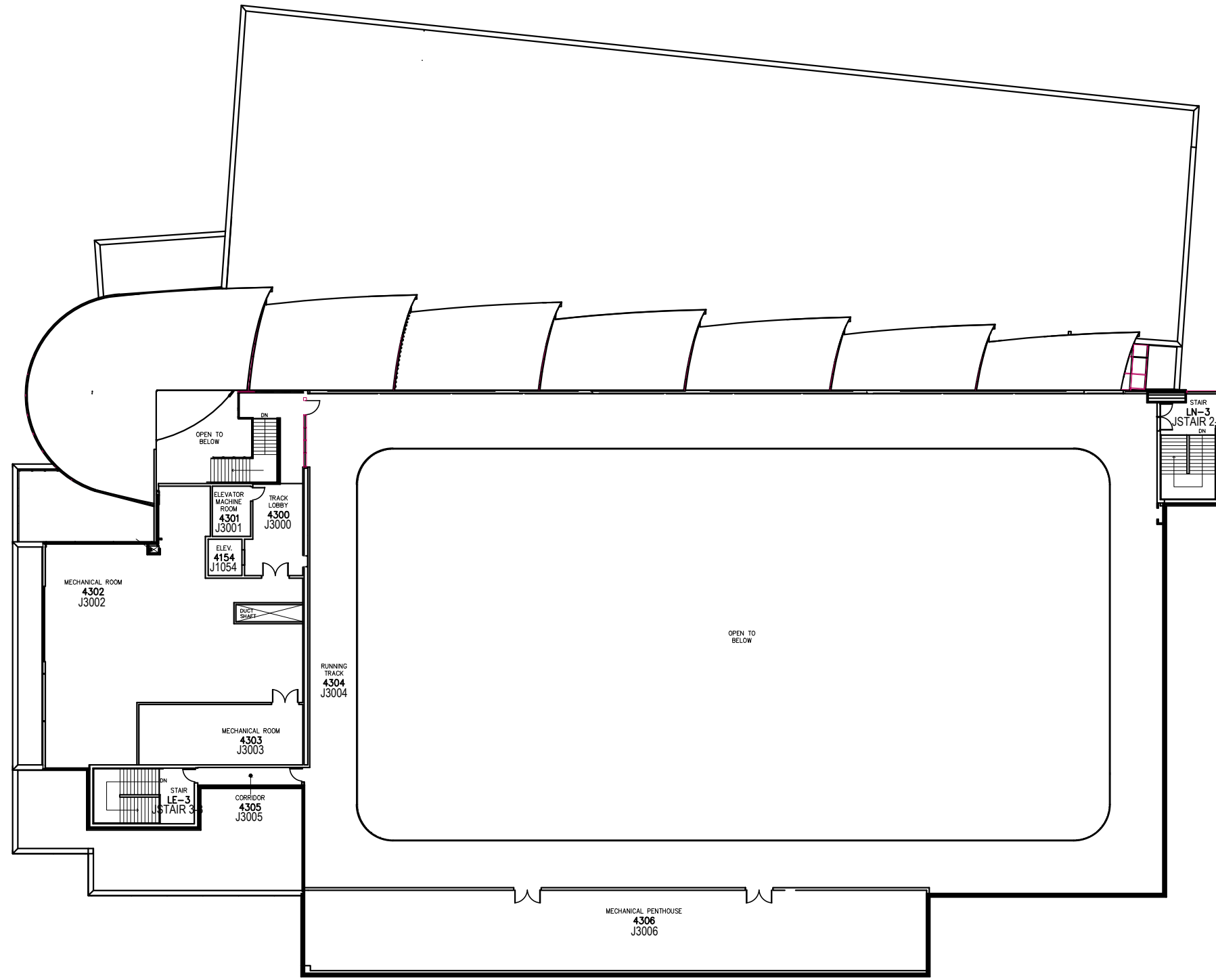

Building 'J' - Third Floor
 Gross Area: 14,806.2 S.F. (1375.50 m²)
 Net Area: 13,062.0 S.F. (1213.46 m²)



FACILITIES MANAGEMENT DEPARTMENT
 2000 Talbot Road West, Windsor, ON N9A 6S4
 Ph: 519-972-2727 Fax: 519-966-7591

DRAWING NAME:
**BUILDING 'J'
 THIRD FLOOR**

REVISED:
FEBRUARY 2023
 FILE NAME: T:\DWG\Building Plans\1 to 30\South
 Campus\1615L3_dwg

REVISED BY: **J.C.**
 SCALE: $\frac{1}{32}'' = 1'-0''$



PAGE:
J3000